

FOUR-JAW TWO MOTION TYPE POWER CHUCK

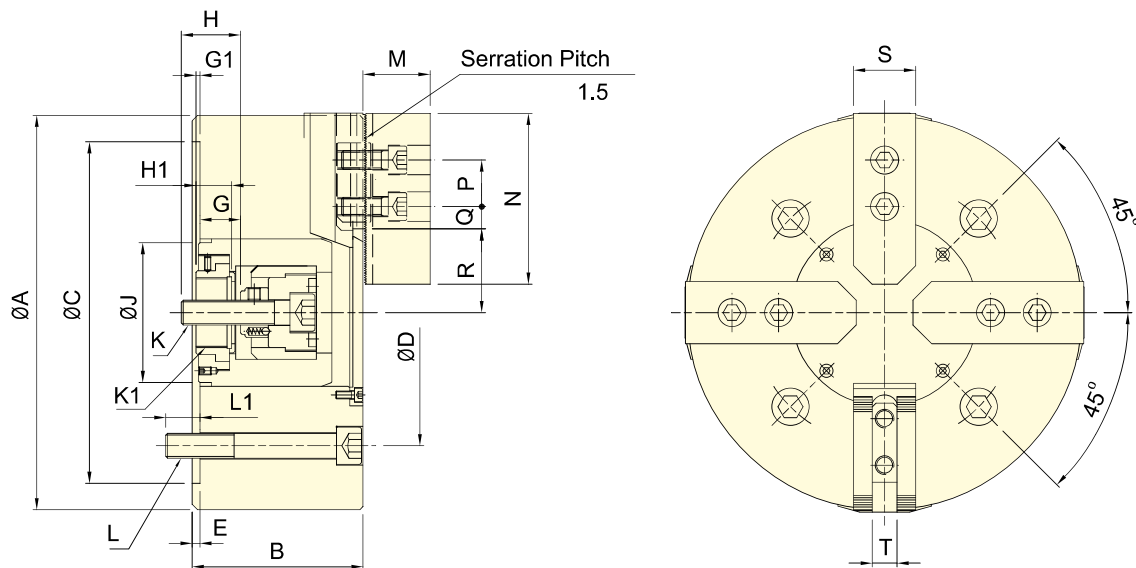

- It's a CRANK type with two pairs of 2 jaws self center independent of each other.
- The 4T series is suitable for square bar and other nonuniform shaped workpieces.



Subject to technical changes.

Spec. Model	Plunger stroke mm	Jaw stroke(Dia.) mm	Chucking Range mm		Max. D.B. pull kN(kgf)	Max. clamping force kN(kgf)	Max. speed min ⁻¹ (r.p.m)	I kg·m ²	Weight kg	Matching cyl.	Max. pressure Mpa (kgf/cm ²)
			Max.	Min.							
4T-08	17	13.6	210	24	16.0(1630)	54.3(5540)	3000	0.15	23.2	RD-120(N)	1.7(17)
4T-10	20	16	254	50	21.6(2200)	79.4(8100)	2100	0.35	44.3	RD-125(N)	2.2(22)
4T-12			304								
4T-15	25	19.6	381	60	27.2(2780)	105.3(10750)	1200	2.25	118.3		

Size Model	A	B	C (H6)	D	E	G _{max.}	G _{min.}	G1 _{max.}	G1 _{min.}	H	H1	J	K
4T-08	210	91	170	133.4	5	32	15	4	-13	29	20	66	M14x2
4T-10	254	110	220	171.4		36.5	16.5	10	-10	36	23	90	M16x2
4T-12	304												
4T-15	381	135	300	235	6	44.5	19.5	5	-20	45	28	125	M20x2.5

Size Model	K1	L	L1	M	N	P	Q _{max.}	Q _{min.}	R _{max.}	R _{min.}	S	T
4T-08	M34x1.5	4~M12	20	38	95	25	25.25	13.25	46.1	39.3	35	14
4T-10	M45x1.5	4~M16		25	43	110	30	32.25	12.75	59	51	40
4T-12			56.75					13.25				
4T-15	M55x2	4~M20	30	51	130	30	66.5	12.5	78.9	69.1	50	21